

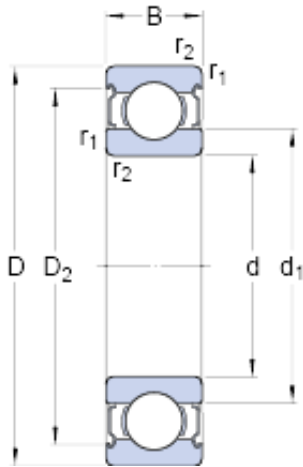

BEARING INDUSTRIA CUSCINETTI S.P.A.



50 mm x 65 mm x 7 mm skf W 61810-2Z Deep groove ball bearings

Bearing No. W 61810-2Z

W 61810-2Z Bearing 2D drawings and 3D CAD models

Size	65x50x7 mm
Bore Diameter	65 mm
Outer Diameter	50 mm
Width	7 mm
d	50 mm
D	65 mm
B	7 mm
d ₁	54.67 mm
D ₂	61.55 mm
r _{1,2} - min.	0.3 mm
d _a - min.	52 mm
d _a - max.	54.5 mm
D _a - max.	63 mm
r _a - max.	0.3 mm
Basic dynamic load rating - C	5.1 kN
Basic static load rating - C ₀	5.5 kN
Fatigue load limit - P _u	0.236 kN
Reference speed	20000 r/min
Limiting speed	10000 r/min
Calculation factor - k _r	0.02
Calculation factor - f ₀	15.3
d ₁	54.67 mm
D ₂	61.55 mm
r _{1,2} min.	0.3 mm



BEARING INDUSTRIA CUSCINETTI S.P.A.

d_a min.	52 mm
d_a max.	54.5 mm
D_a max.	63 mm
r_a max.	0.3 mm
Basic dynamic load rating C	5.07 kN
Basic static load rating C_0	5.5 kN
Fatigue load limit P_u	0.236 kN
Calculation factor k_r	0.02
Calculation factor f_0	15.3
Mass bearing	0.05 kg