

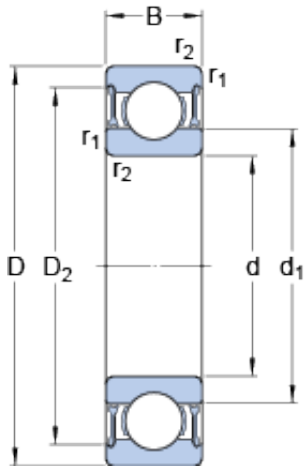

BEARING INDUSTRIA CUSCINETTI S.P.A.



61806-2RZ Bearing 2D drawings and 3D CAD models

30 mm x 42 mm x 7 mm skf 61806-2RZ Deep groove ball bearings

Bearing No. 61806-2RZ

Size	42x30x7 mm
Bore Diameter	42 mm
Outer Diameter	30 mm
Width	7 mm
d	30 mm
D	42 mm
B	7 mm
d ₁	33.7 mm
D ₂	39.4 mm
r _{1,2} - min.	0.6 mm
d _a - min.	32 mm
d _a - max.	33.6 mm
D _a - max.	40 mm
r _a - max.	0.3 mm
Basic dynamic load rating - C	4.5 kN
Basic static load rating - C ₀	2.9 kN
Fatigue load limit - P _u	0.146 kN
Reference speed	32000 r/min
Limiting speed	16000 r/min
Calculation factor - k _r	0.015
Calculation factor - f ₀	13.9
Category	Single Row Ball Bearings
Inventory	0.0
Manufacturer Name	SKF



BEARING INDUSTRIA CUSCINETTI S.P.A.

Minimum Buy Quantity	N/A
Weight / Kilogram	0.028
Product Group	B00308
Enclosure	2 Seals
Precision Class	ABEC 1 ISO P0
Maximum Capacity / Filling Slot	No
Rolling Element	Ball Bearing
Snap Ring	No
Internal Special Features	No
Cage Material	Steel
Enclosure Type	Non-Contact Seal
Internal Clearance	C0-Medium
Inch - Metric	Metric
Long Description	30MM Bore; 42MM Outside Diameter; 7MM Outer Race Diameter; 2 Seals; Ball Bearing; ABEC 1 ISO P0; No Filling Slot; No Snap Ring; No Internal Special Features
Category	Single Row Ball Bearing
UNSPSC	31171504
Harmonized Tariff Code	8482.10.50.68
Noun	Bearing
Keyword String	Ball
Manufacturer URL	http://www.skf.com
Manufacturer Item Number	61806-2RZ
Weight / LBS	0.061
Outer Race Width	0.276 Inch 7 Millimeter
Outside Diameter	1.654 Inch 42 Millimeter
Bore	1.181 Inch 30 Millimeter
bore diameter:	30 mm
dynamic load capacity:	4.49 kN



BEARING INDUSTRIA CUSCINETTI S.P.A.

outside diameter:	42 mm
static load capacity:	2.9 kN
overall width:	7 mm
precision rating:	Not Rated
bore type:	Round
finish/coating:	Uncoated
closure type:	Double Sealed
cage material:	Steel
row type & fill slot:	Single Row Non-Fill Slot
outer ring width:	7 mm
snap ring included:	Without Snap Ring
fillet radius:	0.3 mm
internal clearance:	C0
maximum rpm:	16000 RPM
operating temperature range:	-40 to +210 ° F
series:	61
d_1	33.7 mm
D_2	39.4 mm
$r_{1,2}$ min.	0.6 mm
d_a min.	32 mm
d_a max.	33.6 mm
D_a max.	40 mm
r_a max.	0.3 mm
Basic dynamic load rating C	4.49 kN
Basic static load rating C_0	2.9 kN
Fatigue load limit P_u	0.146 kN
Calculation factor k_r	0.015
Calculation factor f_0	13.9
Mass bearing	0.025 kg